

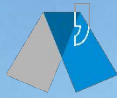

# DIABETES PREVENTING THE PREVENTABLES (DPP) FORUM

2 August 2020 | Kowloonbay International Trade & Exhibition Centre



亞洲糖尿病基金會  
Asia Diabetes Foundation



[dpp2020.adf.org.hk](http://dpp2020.adf.org.hk)

At the end of the forum, participants should be able to:

- Recognize the importance of using multidisciplinary care to empower and engage patients during their life journey of living with diabetes;
- Acquire latest knowledge in the fields of quality improvement and use of latest technologies to improve clinical outcomes;
- Understand the opportunities and challenges in using community and societal approaches to raise awareness and prevent diabetes and non-communicable disease.

Co-organizer:



香港糖尿科護士協會  
Association of Hong Kong Diabetes Nurses

Supporting organizations:



香港醫學會  
THE HONG KONG  
MEDICAL ASSOCIATION



香港家庭醫學學院  
The Hong Kong College of Family Physicians

Enquiry:

Asia Diabetes Foundation

Unit K, 4/F, Haribest Industrial Building, 45-47 Au Pui Wan Street, Shatin, New Territories, Hong Kong

Tel: (852) 2637 6624

E-mail: [dpp.secretariat@adf.org.hk](mailto:dpp.secretariat@adf.org.hk)

*We look forward to seeing you!*

## 2 August (Sunday)

08:45 – 09:25	Registration
09:25 – 09:30	Welcome remarks

### Symposium 1

09:30 – 10:00	Micro vs macronutrients in diabetes and noncommunicable disease (NCD)	Suey Yeung
10:00 – 10:30	Intermittent fasting vs conventional caloric restriction in weight reduction	TBC
10:30 – 10:45	Coffee break	
10:45 – 11:15	Sleep, obesity and diabetes – what's new?	Alice Kong

### Symposium 2 (supported by Sanofi)

11:15 – 11:45	Glycaemic variability and time-in-range during initiation and self-titration of insulin therapy	Elaine Chow
11:45 – 12:15	Impacts of early combination oral and injectable therapy in type 2 diabetes	Enoch Wu

### Abbott Lunch Symposium

12:15 – 13:15	Lunch	
13:15 – 14:00	Coronavirus and diabetes	Norman Chan

### Symposium 3

14:00 – 14:30	How common and serious is fatty liver in type 2 diabetes?	Vincent Wong
14:30 – 15:00	Cognition in diabetes	TBC
15:00 – 15:15	Coffee break	
15:15 – 15:45	Role of metformin in preventing dementia in diabetes	Timothy Kwok

### Symposium 4

15:45 – 16:00	What is the role of biogenetic markers in personalizing diabetes care?	TBC
16:00 – 16:15	What is the role of community-based health care centre in prevention of diabetes and NCD?	Harriet Chung
16:15 – 17:15	A multidisciplinary case forum <ul style="list-style-type: none"> <li>• 1 case presented by specialist</li> <li>• 1 case presented by family doctor</li> </ul>	Man Wo Tsang & Alvin Chan
17:15 - 17:25	Closing remarks	

## REGISTRATION

Category	Local (delegates from Hong Kong and Macau)	Overseas (delegates from outside Hong Kong and Macau)
Medical Professionals	HKD500	USD240
Nurses / Allied Healthcare Professionals	HKD250	USD180
Undergraduate / Post-graduate Students	HKD100	N/A